

**APPLICATIONS**  
**Cadillac DTS 2006-2009**  
**Cadillac SRX 2007-2009**

**CT23CA05**

**KIT FEATURES**

- DIN Radio Provision with Pocket
- ISO Mount Radio Provision with Pocket
- Double DIN Radio Provision
- Stacked ISO Mount Units Provision



**KIT COMPONENTS**

- A) Radio Housing • B) ISO Trim Plate • C) ISO Brackets • D) Double DIN Trim Plate  
• E) Double DIN Brackets • F) Pocket

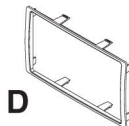
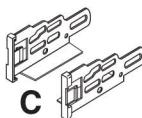
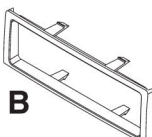
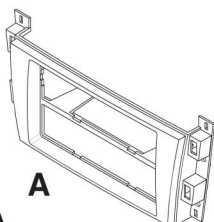

**A**

**B**

**C**

**D**

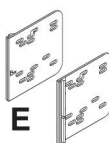
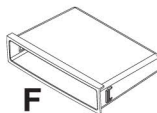

**F**

**E**

**WIRING AND ANTENNA CONNECTIONS**  
(Sold Separately)

- GMOS-LAN-01 - GM LAN Interface 2006-up
- GMOS-LAN-02 - GM LAN Amplified-Interface 2006-up
- GMOS-LAN-05 - GM Digital LAN Amp Interface With Onstar 2007-up
- Antenna Adapter:  
40-CR10 - Chrysler/GM Antenna Adapter 2002-up

**TOOLS REQUIRED:**

- Small Flat Blade Screwdriver/ Panel Removal Tool  
• Phillips Screwdriver • Socket Set



# **TABLE OF CONTENTS**

## **Dash Disassembly**

### **Chevrolet**

**- Cadillac DTS 2006-2009 .....1**

**- Cadillac SRX 2007-2009 .....2**

## **Kit Assembly**

**DIN Radio Provision with Pocket ..... 3**

**ISO Mount Radio Provision with Pocket ..... 4**

**Double DIN Radio Provision ..... 5**

**Final Assembly ..... 6**

**• Refer also to the instructions included with the aftermarket radio.**

## **Cadillac DTS 2006-2009**

- 1** Disconnect the negative battery terminal to prevent an accidental short circuit.
- 2** Unclip and remove the trim panel around the radio, climate controls and ac vents and above glove box. **(Figure A)**
- 3** Remove (4) 9/32" screws securing the a/c vent panel. Unplug and remove the panel. **(Figure B)**
- 4** Remove (4) 9/32" screws securing the climate controls. Unplug and remove the climate controls. **(Figure C)**
- 5** Remove (4) 9/32" screws securing the radio. Unplug and remove the radio. **(Figure D)**

*Continue to kit assembly.*

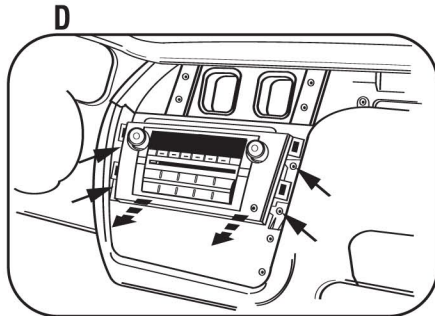
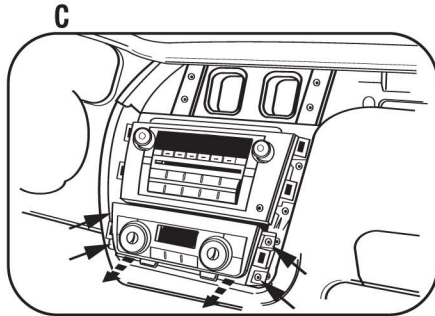
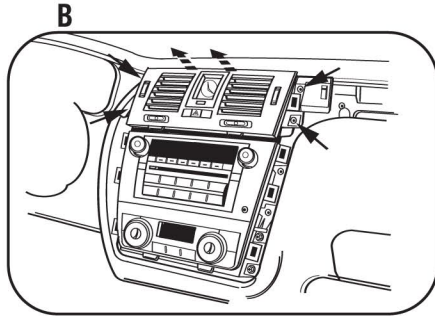
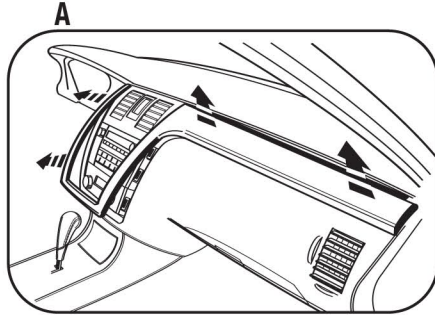

## **Cadillac SRX 2007-2009**

**1** Disconnect the negative battery terminal to prevent an accidental short circuit.

**2** Unclip and remove trim piece between shifter and cup holders. **(Figure A)**

**3** Unclip and remove the trim panel around the radio, climate controls, ac vents and front half of center console. **(Figure B)**

**4** Remove (3) 9/32" screws securing the a/c vent panel and remove the panel. **(Figure C)**

**5** Remove (4) 9/32" screws securing the climate controls. Unplug and remove the climate controls. **(Figure D)**

**6** Remove (4) 9/32" screws securing the radio. Unplug and remove the radio. **Figure E)**

*Continue to kit assembly.*

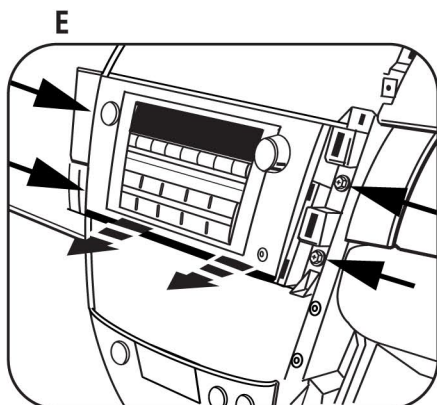
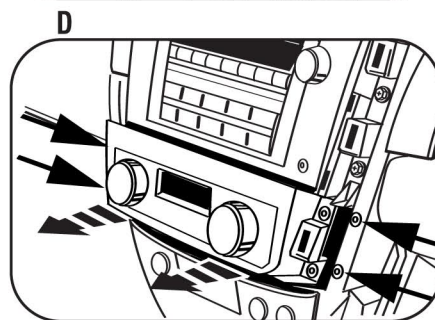
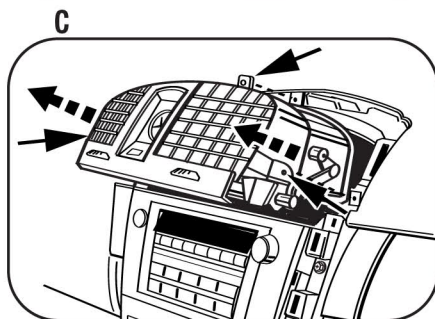
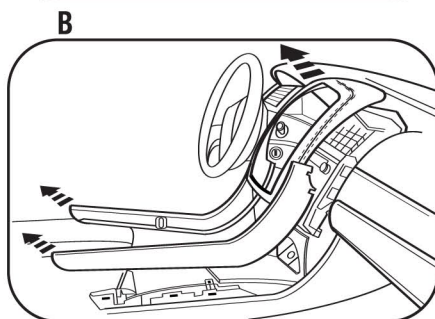
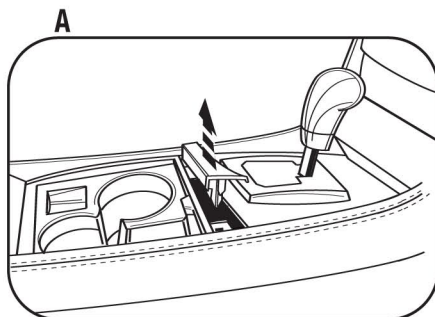

## DIN RADIO PROVISION WITH POCKET

***\*Note:** Refer also to the instructions included with the aftermarket radio.*

- 1 Slide the DIN cage into the Radio Housing and secure by bending the metal locking tabs outward. (Figure A)
- 2 Slide the aftermarket radio into the cage until it snaps into place. (Figure B)
- 3 Snap the pocket into the housing. (Figure C)

*Continue to final assembly.*

**A**

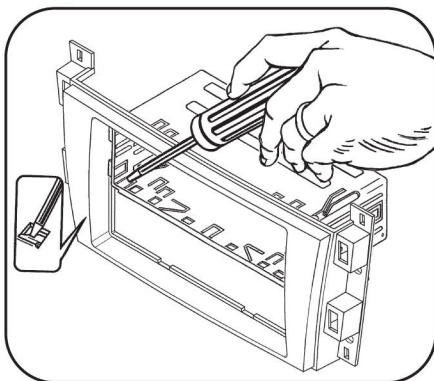

**B**

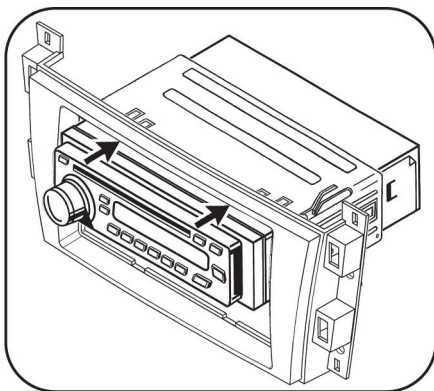

**C**

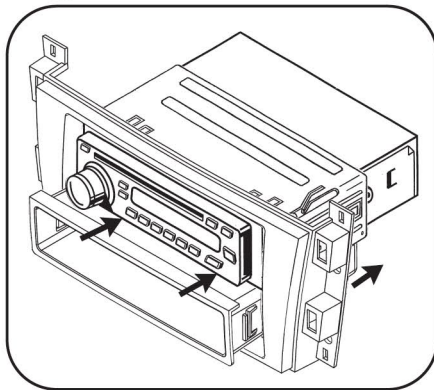

## ISO MOUNT RADIO PROVISION WITH POCKET

*\*Note: Refer also to the instructions included with the aftermarket radio.*

- 1 Mount the ISO Brackets to the radio using the screws supplied with the radio. (Figure A)
- 2 Slide the radio into the radio housing until it snaps into place. (Figure B)
- 3 Snap the trim plate onto the front of the radio housing. (Figure B)
- 4 Snap the pocket into the housing. (Figure C)

*Continue to final assembly.*

A

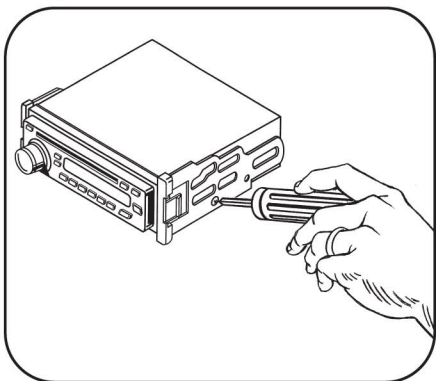

B

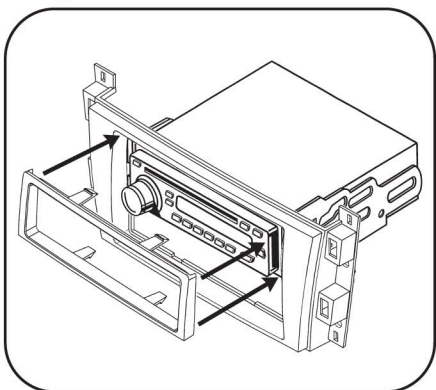

C

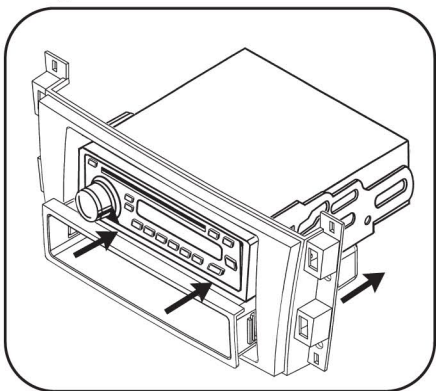



## DOUBLE DIN RADIO PROVISION

*\*Note: Refer also to the instructions included with the aftermarket radio.*

- 1** Cut and remove the center bar from the radio housing. (Figure A)
- 2** Snap the Double DIN brackets to the inside edge of the radio housing. (Figure B)
- 3** Slide the Double DIN radio or stacked ISO mount units into the bracket/radio housing assembly then secure to the assembly using the screws supplied with the radio or ISO mount units. (Figure C)
- 4** Snap the Double DIN Trim plate onto the front of the Radio Housing. (Figure C)

*Continue to final assembly.*

**A**

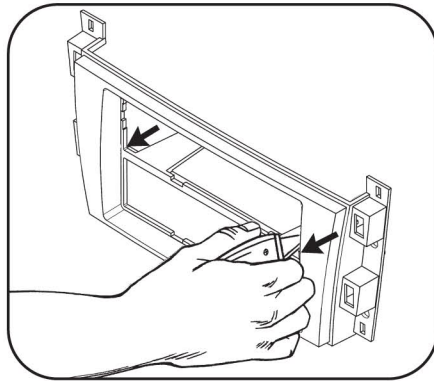

**B**

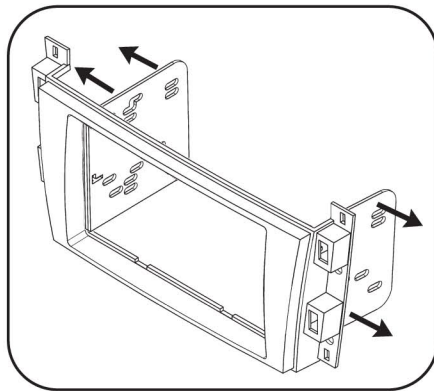

**C**

